

Start device 2703

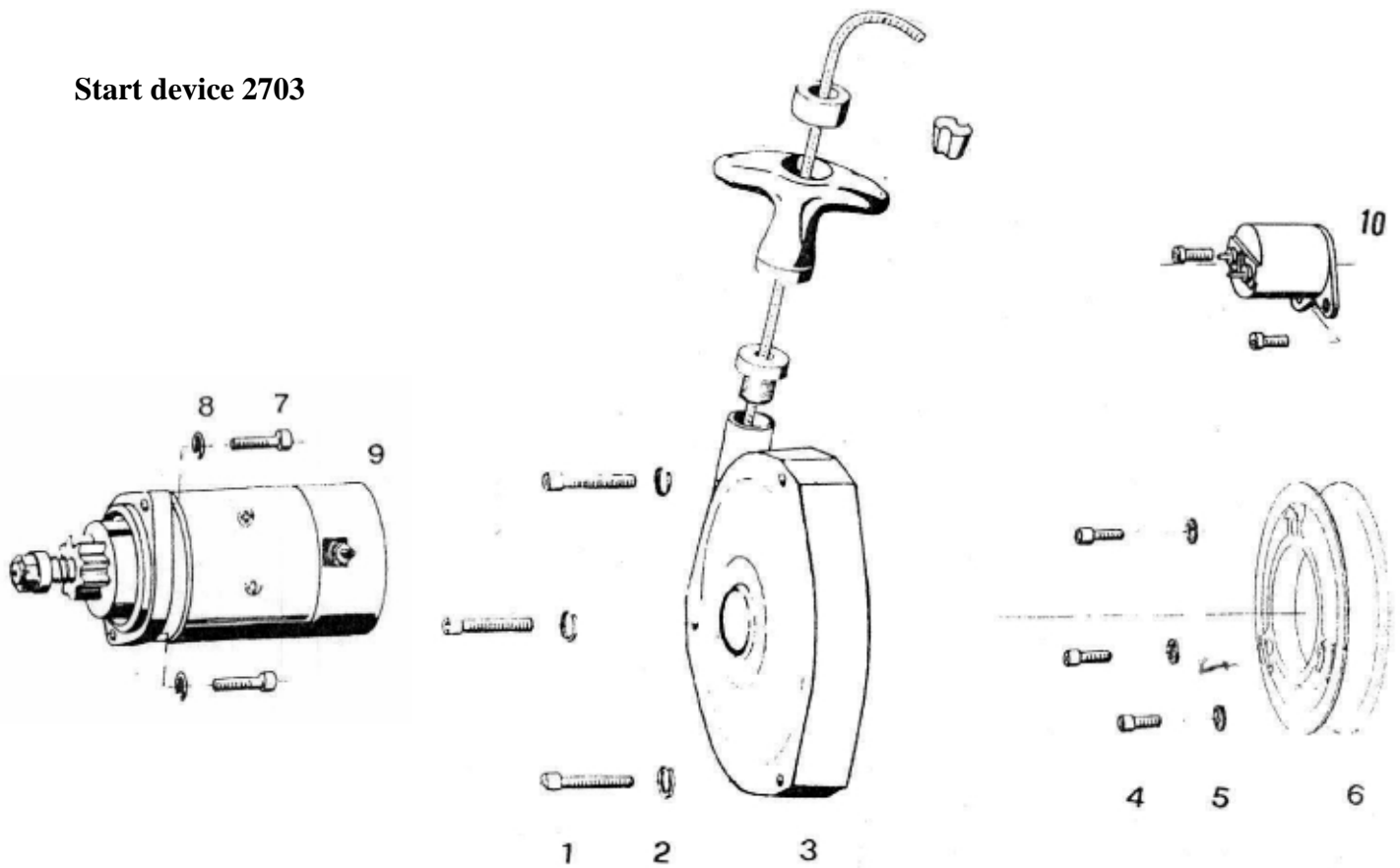

Fig. No.	Quantity	Designation	Part No.	Neoteric Part No	Remark
1	3	Cylinder screw	DIN 912 M6x35	6911	Md = 9,6...11 Nm
2	3	Spring ring	DIN 7980 6	6940	
3	1	Starter, mounted	265 A1U	5267	
4	3	Cylinder screw	DIN 6912 M8x35		Md = 23...28 Nm
5	3	Tab washer	053.8/8	5995	
6*		Driving dog with starter, Flat		6203	
6*	1	Driving dog with starter, Poly-V	275 AB3U	6389	
7	2	Cylinder screw	DIN 912 M8x30	2348	Md = 23...28 Nm
-	2	Cylinder screw	275 L1		With starter 028.12 mounted
8	2	Tab washer	058.8/8	5995	
9	1	E-starter	028.10	6498	
-	1	Solenoid starter	028.12	5417	choose
10	1	Starter-relay	032.20	6522	

*** Optional Catch Pulley PolyV**