

## Start device 3203

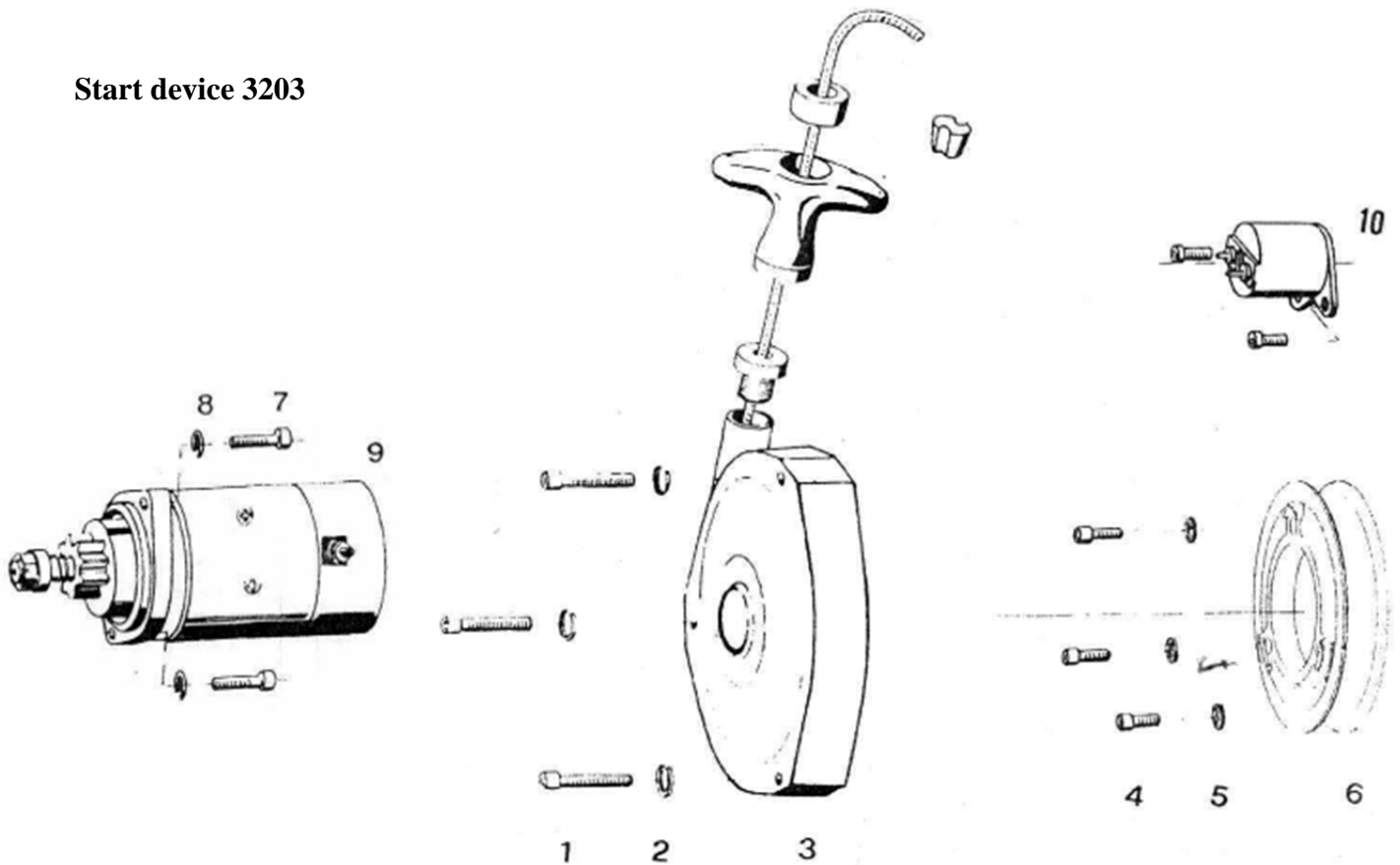

| Fig. No. | Quantity | Designation                      | Part No.       | Neoteric Part No | Remark   |
|----------|----------|----------------------------------|----------------|------------------|--|
| 1        | 3        | Cylinder screw                   | DIN 912 M6x35  | <b>6911</b>      | Md = 9,6...11 Nm   |
| 2        | 3        | Spring ring                      | DIN 7980 6     | <b>6940</b>      |  |
| 3        | 1        | Starter, mounted                 | 265 A1U        | <b>5267</b>      |  |
| 4        | 3        | Cylinder screw                   | DIN 6912 M8x35 |                  | Md = 23...28 Nm  |
| 5        | 3        | Tab washer                       | 053.8/8        | <b>5995</b>      |  |
| 6*       |          | Driving dog with starter, Flat   |                | <b>6189</b>      | *Used up to model year 2008 (Engine #901105 & Lower)       |
| 6        | 1        | Driving dog with starter, Poly-V | 275 AB3U       | <b>6389</b>      | Currently used, from 2008 onward (Engine #901106 & Higher) |
| 7        | 2        | Cylinder screw                   | DIN 912 M8x30  | <b>2348</b>      | Md = 23...28 Nm  |
| -        | 2        | Cylinder screw                   | 275 L1         |                  | With starter 028.12 mounted                                |
| 8        | 2        | Tab washer                       | 058.8/8        | <b>5995</b>      |  |
| 9        | 1        | E-starter                        | 028.10         | <b>6498</b>      |  |
| -        | 1        | Solenoid starter                 | 028.12         | <b>5417</b>      |  |
| 10       | 1        | Starter-relay                    | 032.20         | <b>6522</b>      |  |