

## Start device 2703

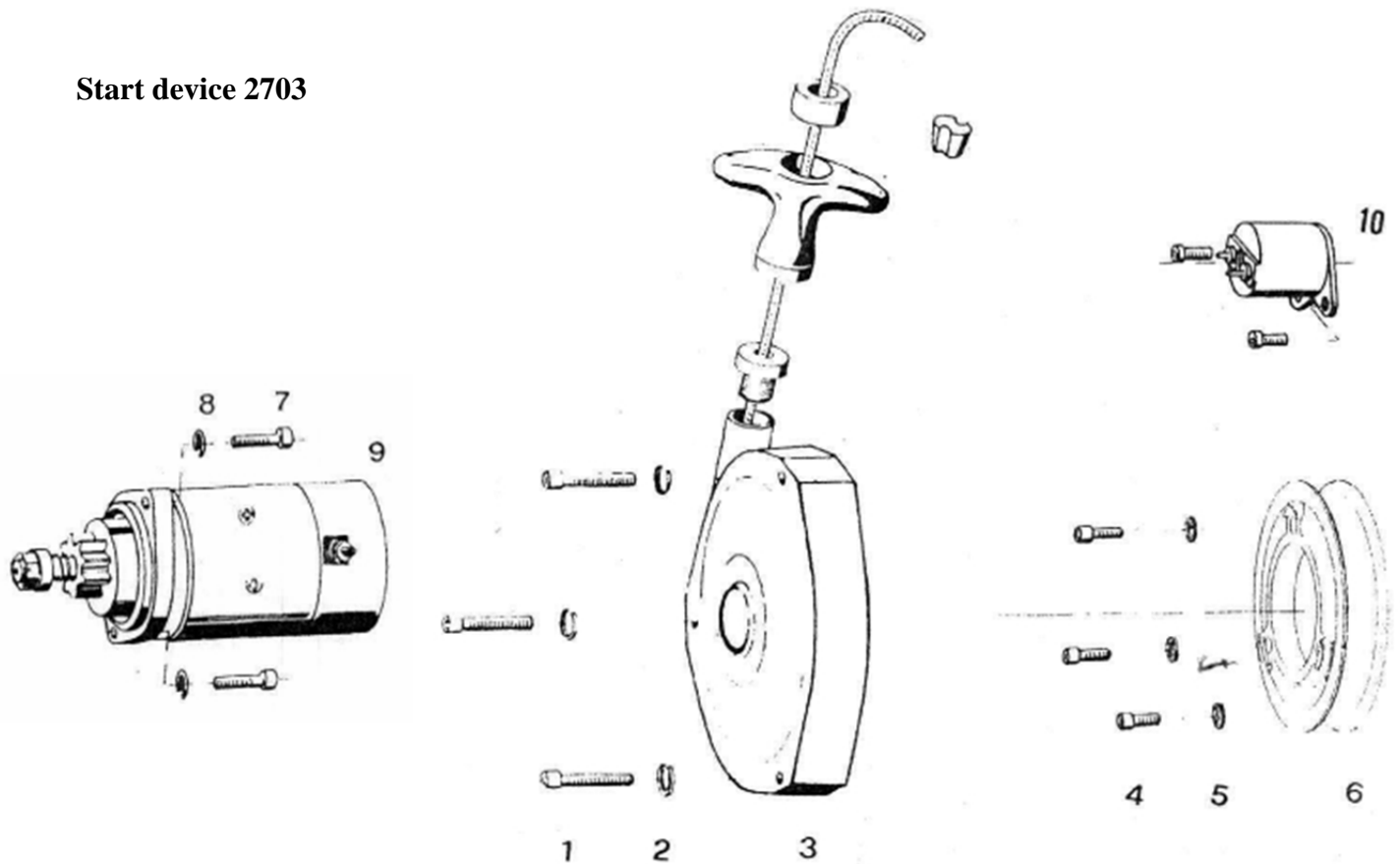

Fig. No.	Quantity	Designation	Part No.	Neoteric Part No	Remark
1	3	Cylinder screw	DIN 912 M6x35	<b>6911</b>	Md = 9,6...11 Nm
2	3	Spring ring	DIN 7980 6	<b>6940</b>	
3	1	Starter, mounted	265 A1U	<b>5267</b>	
4	3	Cylinder screw	DIN 6912 M8x35		Md = 23...28 Nm
5	3	Tab washer	053.8/8	<b>5995</b>	
6*	1	Driving dog with starter, Flat		<b>6203</b>	*Used up to model year 2008 (Engine #901105 & Lower)
6	1	Driving dog with starter, Poly-V	275 AB3U	<b>6389</b>	Currently used, from 2008 onward (Engine #901106 & Higher)
7	2	Cylinder screw	DIN 912 M8x30	<b>2348</b>	Md = 23...28 Nm
-	2	Cylinder screw	275 L1		With starter 028.12 mounted
8	2	Tab washer	058.8/8	<b>5995</b>	
9	1	E-starter	028.10	<b>6498</b>	
-	1	Solenoid starter	028.12	<b>5417</b>	
10	1	Starter-relay	032.20	<b>6522</b>	